

Liquidtight Fittings

For Threaded RMC and IMC

Type 4Q-FM - Combination Couplings

Use:

Secures, grounds and seals liquidtight flexible metal conduit to threaded rigid conduit and IMC.

Features:

- Female hub, NPT for connection to threaded conduit
- Liquidtight/Raintight/Oiltight/Concretetight
- UL Listed NEMA Type 4 when installed into a NPT threaded entry or UL Listed conduit hub (sizes 1¼" and larger require thread sealant).
- Suitable for grounding through 1¼" Trade Size per NEC Section 250.118(7)
- For Trade Sizes 1½" and larger, an internal or external equipment bonding conductor is required. See 4Q-L Series with external ground lug in Catalog Section GB.
- Suitable for use in the following Hazardous Locations:
 - Class I, Div. 2 per NEC 501.4(B)
 - Class I, Zone 2 per NEC 505.15(C)(2)
 - Class II, Div. 1 per NEC 502.4(A)(1)(e)
 - Class II, Div. 2 per NEC 502.4(B)(2)
 - Class III, Div. 1 per NEC 503.3(A)(2)
 - Class III, Div. 2 per NEC 503.3(B)
- Intrinsically Safe per NEC 504.20
- Bonding Wedge Locknuts are recommended in Hazardous Locations. See 101 Series on Page DB8.
- Suitable for wet locations
- Long ferrule prevents pullout and tight bend conduit "pop-out"
- Reusable ferrule
- Inspection windows in ferrule to ensure full engagement
- See Page GC4 for our patented Ferrule Wrench which makes ferrule installation easy.

Material/Finish:

Malleable Iron/Zinc Plated
Steel Ferrule/Zinc Plated

Optional Finish:

Hot Dip or Mechanical Galvanize, add suffix "G" to catalog number. Contact your local representative for pricing and availability.

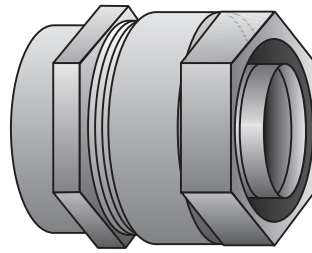

Type 4Q-38FM — Type 4Q-200FM

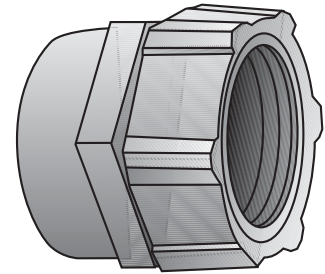

Type 4Q-250FM — Type 4Q-500FM

Trade Size (inches)	Catalog Number	Dimensions in Inches		
		A	B	C
⅜ (½ KO)	4Q-38FM	1 ¹¹ / ₁₆	1 ³ / ₁₆	1 ¹ / ₈
½	4Q-50FM	1 ¹ / ₁₆	1 ¹ / ₁₆	1 ¹ / ₄
¾	4Q-75FM	1 ⁵ / ₈	1 ¹ / ₁₆	1 ¹ / ₂
1	4Q-100FM	1 ¹³ / ₁₆	1 ¹³ / ₁₆	1 ³ / ₄
1¼	4Q-125FM	2	2 ³ / ₈	2 ¹ / ₂
1½	4Q-150FM	2 ¹ / ₈	2 ⁵ / ₈	2 ³ / ₄
2	4Q-200FM	2 ¹ / ₄	3 ¹ / ₄	3 ³ / ₄
2½	4Q-250FM	3 ¹ / ₄	3 ⁷ / ₈	4 ¹ / ₈
3	4Q-300FM	3 ³ / ₈	4 ¹ / ₈	4 ¹ / ₈
3½	4Q-350FM	3 ⁵ / ₈	5 ³ / ₈	4 ¹ / ₈
4	4Q-400FM	3 ³ / ₄	5 ¹ / ₄	6 ¹ / ₈
5	4Q-500FM•	3 ⁵ / ₈	6 ¹ / ₈	7 ¹ / ₈

•UL Listing not applicable

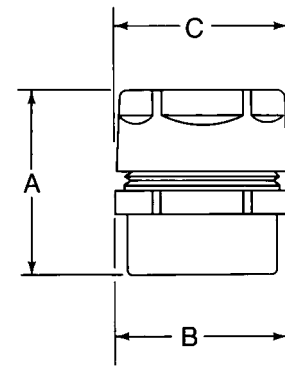

Third Party Certification:



UL Listed: 11853



CSA Certified: 009795

Applicable Third Party Standards:

UL Standard: 514B

CSA Standard: C22.2 No. 18

NEMA: FB-1

Federal Spec: W-F-406E