



QL-500K



QL-1505K



FEATURES-SPECIFICATIONS

Applications

Provides maximum light output with low initial cost. Designed for instant turn-on and high illumination levels where H.I.D. costs are prohibitive. Used to illuminate construction sites, security areas, sports areas, sign lighting and other applications.

QL Series Features

- **Tempered Glass Lens Assembly**—Thermal shock-and impact-resistant glass lens mounted in a die cast aluminum door frame
- **Cast Aluminum Housing**—The cast aluminum body is designed with a specialized heat dissipating fin system for cooler operation
- **Versatile Mounting**—The standard unit has a 1/2 inch swivel knuckle with cast construction for strength and durability
- **High Temperature Gasketing**—A weathertight seal is provided by a high temperature silicone door gasket
- **Exclusive Socket System**—This two-piece, high temperature socket allows easy relamping and prevents socket from binding
- **Reflector**—Linear parabolic reflector system provides maximum light output and control

- **High Temperature Gasketing**—A weathertight seal is provided by a high temperature silicone gasket attached to the housing. Four lens clips positively seal the lens to the gasket with consistent pressure to assure a weathertight seal
- **Versatile Mounting**—The standard unit has a 1/2 inch swivel knuckle with cast construction for strength and universal aiming
See photometric data for QL Series fixtures on page L187.

QL QUARTZ FLOODLIGHTS				
CATALOG NUMBER	LAMP AND WATTAGE	BEAM SPREAD	WEIGHT	E.P.A. SQ. FT.
QL-500K [Ⓛ]	300/500	Wide	4 Lbs. (1.8)	.53
QL-500K-WQ [Ⓜ]	300/500	Wide	4 Lbs. (1.8)	.53
QL-1505K [Ⓢ]	1000/1500	Wide	6 Lbs. (2.7)	.86
QL-1505K-WQ ^{ⓈⓂ}	1000/1500	Wide	6 Lbs. (2.7)	.86

[Ⓛ] Lamps not included.

[Ⓜ] Lamps supplied-shipped separately. 500W 120V, 1500 240V.

[Ⓢ] 1500W models must be aimed 10° or more below horizontal.

ACCESSORIES/REPLACEMENT PARTS		
DESCRIPTION	QL-500K	QL-1505K
Guard	QL-5G	QL-15G
Trunnion Box	QL-TB	
Lens ONLY	0461330B	0461331B
Socket (2 Required)	K800-2166-0108	0732016B
1/2" Knuckle	K20750110214	
Lens Gasket	K265-0481-0307	

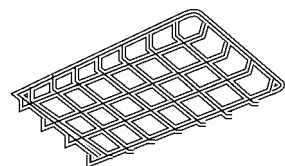

Guard

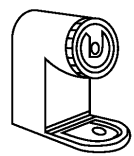

Trunnion Box

Dimensions

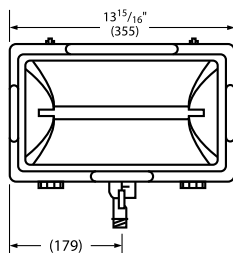

QL-1500 Watt

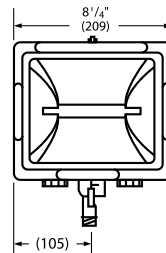

QL-500 Watt

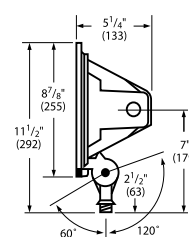

QL-1500 and QL-500 Watt

