

Stainless Steel Feed-Through NEMA Type 4X Wireway

Stainless Steel Feed-Through NEMA Type 4X 90° Elbow

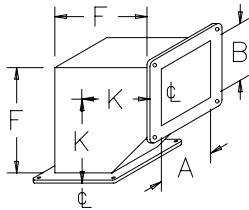

87797206

Catalog Number	A x B in. (mm)	F (in.)	F (mm)	K (in.)	K (mm)
F44WE90SS	4.00 x 4.00 (102 x 102)	7.00	178	5.00	127
F66WE90SS	6.00 x 6.00 (152 x 152)	9.00	229	6.00	152

Stainless Steel Feed-Through NEMA Type 4X Tee

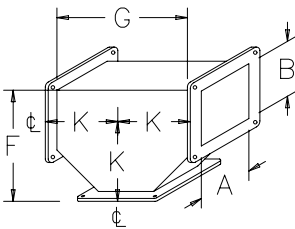

87797208

Catalog Number	A x B in. (mm)	F (in.)	F (mm)	G (in.)	G (mm)	K (in.)	K (mm)
F44WTSS	4.00 x 4.00 (102 x 102)	7.00	178	10.00	254	5.00	127
F66WTSS	6.00 x 6.00 (152 x 152)	9.00	229	12.00	305	6.00	152

Stainless Steel Feed-Through NEMA Type 4X Closure Plate

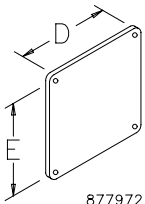

87797211

Used to seal the end of a wireway section or run.

Catalog Number	D (in.)	D (mm)	E (in.)	E (mm)
F44WPSS	5.38	137	5.38	137
F66WPSS	7.62	194	7.62	194

Stainless Steel Feed-Through NEMA Type 4X Reducer Bushings, Center Hole

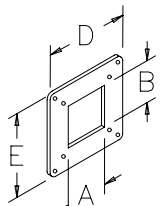

87797213

Used to reduce to a smaller wireway size. The center hole bushing centers the two wireway sizes relative to each other while the edge hole bushing keeps the top surfaces even.

Catalog Number	A x B in. (mm)	D (in.)	D (mm)	E (in.)	E (mm)
F66WR44SS	6.00 x 6.00 (152 x 152)	5.38	137	5.38	137

Stainless Steel Feed-Through NEMA Type 4X Reducer Bushings, Edge Hole

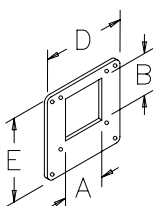

87797214

Used to reduce to a smaller wireway size. The center hole bushing centers the two wireway sizes relative to each other while the edge hole bushing keeps the top surfaces even.

Catalog Number	A x B in. (mm)	D (in.)	D (mm)	E (in.)	E (mm)
F66WRE44SS	6.00 x 6.00 (152 x 152)	5.38	137	5.38	137

Stainless Steel Feed-Through NEMA Type 4X Wireway

Stainless Steel Feed-Through NEMA Type 4X Nipple

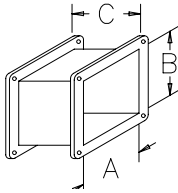

Available in 6.00 in. (152mm) length.

Catalog Number	A x B x C in. (mm)
F44WN6SS	4.00 x 4.00 x 6.00 (102 x 102 x 152)
F66WN6SS	6.00 x 6.00 x 6.00 (152 x 152 x 152)

Stainless Steel Feed-Through NEMA Type 4X Swivel Nipple

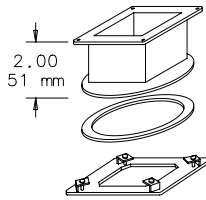

Allows wireway run to be adjusted to any angle. Regular type is used between adjacent wireway sections or fittings.

87797209

Catalog Number	A x B in. (mm)
F44WSCSS	4.00 x 4.00 (102 x 102)

Stainless Steel Feed-Through NEMA Type 4X Drop Hanger

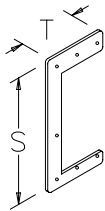

87797215

Catalog Number	S (in.)	S (mm)	T (in.)	T (mm)
F44HDSS	11.75	298	6.00	152
F66HDSS	15.25	387	8.12	206

Stainless Steel Feed-Through NEMA Type 4X Bracket Hanger

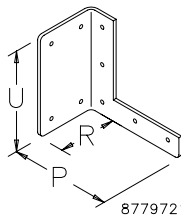

87797216

Catalog Number	P (in.)	P (mm)	R (in.)	R (mm)	U (in.)	U (mm)
F44HBSS	6.12	155	3.62	92	5.88	149
F66HBSS	8.25	210	3.62	92	7.88	200

Stainless Steel Feed-Through NEMA Type 4X Box Connector

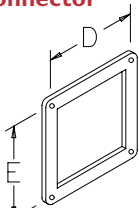

When wireway enters an enclosure, a box connector should be used on the inside of the enclosure to ensure a tight and stable seal.

Catalog Number	D (in.)	D (mm)	E (in.)	E (mm)
F44WBSS	5.38	137	5.38	137
F66WBSS	7.62	194	7.62	194

Stainless Steel Feed-Through NEMA Type 4X Gasket and Screws

Standard packages of wireway contain one gasket and one set of screws to join sections, except "Tee" fittings which contain two of each and "Telescope" fittings which contain none. Additional gasket and screw sets may be ordered by catalog number.

Catalog Number	A x B in. (mm)
F44WGSS	4.00 x 4.00 (102 x 102)
F66WGSS	6.00 x 6.00 (152 x 152)