

**A**

## TYPE CSWD

### Features

- Manufactured from high strength seamless copper tubing
- Electro-Tin plated
- Chamfered entry
- Color coded
- Suitable for use in circuits rated 35KV or less, proper high voltage spacing and insulation techniques must be used
- UL Listed and CSA Certified with ILSCO and major competitor's compression tools
- UL467 Listed 500 kcmil - 8 AWG , #8 - #2 SOL
- Rated to 90° C

### Benefits

- Offers maximum conductivity and excellent crimping characteristics
- Provides low contact resistance
- For easy conductor insertion
- Identifies the proper compression die
- Application versatility
- Reduces inventory requirements
- For grounding and bonding applications

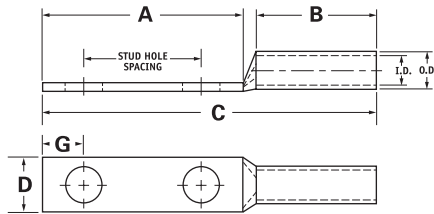

| Catalog Number | Wire Size | Alt Wire Size   | Expanded* Wire Range | Bolt Size | Stud Hole Dia. | Stud Hole Spacing | Dimensions |       |       |       |       | Die Color Code | Die Index | O.D.  | I.D.  |
|----------------|-----------|-----------------|----------------------|-----------|----------------|-------------------|------------|-------|-------|-------|-------|----------------|-----------|-------|-------|
|                |           |                 |                      |           |                |                   | A          | B     | C     | D     | G     |                |           |       |       |
| CSWD-8-10-58   | #8 AWG    | #8 FLEX, #8 SOL | -                    | 10        | 0.219          | 0.625             | 1.250      | 0.500 | 1.945 | 0.374 | 0.258 | Red            | I-21      | 0.272 | 0.179 |
| CSWD-8-10-34   | #8 AWG    | #8 FLEX, #8 SOL | -                    | 10        | 0.219          | 0.750             | 1.437      | 0.500 | 2.132 | 0.374 | 0.258 | Red            | I-21      | 0.272 | 0.179 |
| CSWD-8-14-58   | #8 AWG    | #8 FLEX, #8 SOL | -                    | 1/4       | 0.281          | 0.625             | 1.437      | 0.500 | 2.132 | 0.486 | 0.320 | Red            | I-21      | 0.272 | 0.179 |
| CSWD-8-14-34   | #8 AWG    | #8 FLEX, #8 SOL | -                    | 1/4       | 0.281          | 0.750             | 1.437      | 0.500 | 2.132 | 0.486 | 0.320 | Red            | I-21      | 0.272 | 0.179 |
| CSWD-8-14-1    | #8 AWG    | #8 FLEX, #8 SOL | -                    | 1/4       | 0.281          | 1.000             | 1.687      | 0.500 | 2.382 | 0.486 | 0.320 | Red            | I-21      | 0.272 | 0.179 |
| CSWD-8-38-1    | #8 AWG    | #8 FLEX, #8 SOL | -                    | 3/8       | 0.406          | 1.000             | 1.937      | 0.500 | 2.632 | 0.593 | 0.414 | Red            | I-21      | 0.272 | 0.179 |
| CSWD-6-10-12   | #6 AWG    | #6 FLEX, #6 SOL | -                    | 10        | 0.219          | 0.500             | 1.250      | 0.500 | 1.945 | 0.440 | 0.258 | Blue           | I-24      | 0.320 | 0.225 |
| CSWD-6-10-58   | #6 AWG    | #6 FLEX, #6 SOL | -                    | 10        | 0.219          | 0.625             | 1.250      | 0.500 | 1.945 | 0.440 | 0.258 | Blue           | I-24      | 0.320 | 0.225 |
| CSWD-6-10-1116 | #6 AWG    | #6 FLEX, #6 SOL | -                    | 10        | 0.219          | 0.687             | 1.250      | 0.500 | 1.945 | 0.440 | 0.258 | Blue           | I-24      | 0.320 | 0.225 |
| CSWD-6-10-34   | #6 AWG    | #6 FLEX, #6 SOL | -                    | 10        | 0.219          | 0.750             | 1.437      | 0.500 | 2.132 | 0.440 | 0.258 | Blue           | I-24      | 0.320 | 0.225 |
| CSWD-6-14-12   | #6 AWG    | #6 FLEX, #6 SOL | -                    | 1/4       | 0.281          | 0.500             | 1.250      | 0.500 | 1.945 | 0.440 | 0.320 | Blue           | I-24      | 0.320 | 0.225 |
| CSWD-6-14-58   | #6 AWG    | #6 FLEX, #6 SOL | -                    | 1/4       | 0.281          | 0.625             | 1.437      | 0.500 | 2.132 | 0.440 | 0.320 | Blue           | I-24      | 0.320 | 0.225 |
| CSWD-6-14-34   | #6 AWG    | #6 FLEX, #6 SOL | -                    | 1/4       | 0.281          | 0.750             | 1.437      | 0.500 | 2.132 | 0.440 | 0.320 | Blue           | I-24      | 0.320 | 0.225 |
| CSWD-6-14-1    | #6 AWG    | #6 FLEX, #6 SOL | -                    | 1/4       | 0.281          | 1.000             | 1.687      | 0.500 | 2.382 | 0.440 | 0.320 | Blue           | I-24      | 0.320 | 0.225 |
| CSWD-6-516-34  | #6 AWG    | #6 FLEX, #6 SOL | -                    | 5/16      | 0.343          | 0.750             | 1.687      | 0.500 | 2.382 | 0.530 | 0.352 | Blue           | I-24      | 0.320 | 0.225 |
| CSWD-6-516-1   | #6 AWG    | #6 FLEX, #6 SOL | -                    | 5/16      | 0.343          | 1.000             | 1.937      | 0.500 | 2.632 | 0.530 | 0.352 | Blue           | I-24      | 0.320 | 0.225 |
| CSWD-6-38-34   | #6 AWG    | #6 FLEX, #6 SOL | -                    | 3/8       | 0.406          | 0.750             | 1.687      | 0.500 | 2.382 | 0.598 | 0.414 | Blue           | I-24      | 0.320 | 0.225 |
| CSWD-6-38-78   | #6 AWG    | #6 FLEX, #6 SOL | -                    | 3/8       | 0.406          | 0.875             | 1.937      | 0.500 | 2.632 | 0.598 | 0.414 | Blue           | I-24      | 0.320 | 0.225 |
| CSWD-6-38-1    | #6 AWG    | #6 FLEX, #6 SOL | -                    | 3/8       | 0.406          | 1.000             | 1.937      | 0.500 | 2.632 | 0.598 | 0.414 | Blue           | I-24      | 0.320 | 0.225 |
| CSWD-6-12-134  | #6 AWG    | #6 FLEX, #6 SOL | -                    | 1/2       | 0.562          | 1.750             | 3.000      | 0.500 | 3.695 | 0.755 | 0.546 | Blue           | I-24      | 0.320 | 0.225 |

All wire sizes, unless noted otherwise, are American Wire Gauge (AWG)

\* When installed with specified dieless tools

See pages 98 to 103 for complete tooling information.

For Bent Tangs change the 4th letter to a B and add "-4" for 45 deg. or "-9" for 90 deg.

UL File E6207

## TYPE CSWD

### Features

- Manufactured from high strength seamless copper tubing
- Electro-Tin plated
- Chamfered entry
- Color coded
- Suitable for use in circuits rated 35KV or less, proper high voltage spacing and insulation techniques must be used
- UL Listed and CSA Certified with ILSCO and major competitor's compression tools
- UL467 Listed 500 kcmil - 8 AWG , #8 - #2 SOL
- Rated to 90° C

### Benefits

- Offers maximum conductivity and excellent crimping characteristics
- Provides low contact resistance
- For easy conductor insertion
- Identifies the proper compression die
- Application versatility
- Reduces inventory requirements
- For grounding and bonding applications

**A**

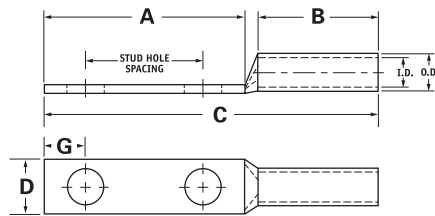

| Catalog Number | Wire Size | Alt Wire Size | Expanded* Wire Range | Bolt Size | Stud Hole Dia. | Stud Hole Spacing | Dimensions |       |       |       |       | Die Color Code | Die Index | O.D.  | I.D.  |
|----------------|-----------|---------------|----------------------|-----------|----------------|-------------------|------------|-------|-------|-------|-------|----------------|-----------|-------|-------|
|                |           |               |                      |           |                |                   | A          | B     | C     | D     | G     |                |           |       |       |
| CSWD-4-10-58   | #4 AWG    | #4 SOL        | 4-6 AWG              | 10        | 0.219          | 0.625             | 1.250      | 0.500 | 1.984 | 0.486 | 0.258 | Gray           | I-29      | 0.343 | 0.250 |
| CSWD-4-10-34   | #4 AWG    | #4 SOL        | 4-6 AWG              | 10        | 0.219          | 0.750             | 1.437      | 0.500 | 2.171 | 0.486 | 0.258 | Gray           | I-29      | 0.343 | 0.250 |
| CSWD-4-10-1    | #4 AWG    | #4 SOL        | 4-6 AWG              | 10        | 0.219          | 1.000             | 1.687      | 0.500 | 2.421 | 0.486 | 0.258 | Gray           | I-29      | 0.343 | 0.250 |
| CSWD-4-14-58   | #4 AWG    | #4 SOL        | 4-6 AWG              | 1/4       | 0.281          | 0.625             | 1.437      | 0.500 | 2.171 | 0.486 | 0.320 | Gray           | I-29      | 0.343 | 0.250 |
| CSWD-4-14-34   | #4 AWG    | #4 SOL        | 4-6 AWG              | 1/4       | 0.281          | 0.750             | 1.437      | 0.500 | 2.171 | 0.486 | 0.320 | Gray           | I-29      | 0.343 | 0.250 |
| CSWD-4-14-1    | #4 AWG    | #4 SOL        | 4-6 AWG              | 1/4       | 0.281          | 1.000             | 1.687      | 0.500 | 2.421 | 0.486 | 0.320 | Gray           | I-29      | 0.343 | 0.250 |
| CSWD-4-516-1   | #4 AWG    | #4 SOL        | 4-6 AWG              | 1/4       | 0.343          | 1.000             | 1.937      | 0.500 | 2.671 | 0.486 | 0.320 | Gray           | I-29      | 0.343 | 0.250 |
| CSWD-4-38-34   | #4 AWG    | #4 SOL        | 4-6 AWG              | 3/8       | 0.406          | 0.750             | 1.687      | 0.500 | 2.421 | 0.593 | 0.414 | Gray           | I-29      | 0.343 | 0.250 |
| CSWD-4-38-1    | #4 AWG    | #4 SOL        | 4-6 AWG              | 3/8       | 0.406          | 1.000             | 1.937      | 0.500 | 2.671 | 0.593 | 0.414 | Gray           | I-29      | 0.343 | 0.250 |
| CSWD-4-12-134  | #4 AWG    | #4 SOL        | 4-6 AWG              | 1/2       | 0.562          | 1.750             | 3.000      | 0.500 | 3.734 | 0.750 | 0.546 | Gray           | I-29      | 0.343 | 0.250 |
| CSWD-3-14-58   | #3 AWG    | #4 FLEX       | 3-6 AWG              | 1/4       | 0.281          | 0.625             | 1.437      | 0.625 | 2.317 | 0.532 | 0.320 | White          | I-29      | 0.375 | 0.275 |
| CSWD-3-14-34   | #3 AWG    | #4 FLEX       | 3-6 AWG              | 1/4       | 0.281          | 0.750             | 1.437      | 0.625 | 2.317 | 0.532 | 0.320 | White          | I-29      | 0.375 | 0.275 |
| CSWD-3-516-1   | #3 AWG    | #4 FLEX       | 3-6 AWG              | 5/16      | 0.343          | 1.000             | 1.937      | 0.625 | 2.817 | 0.532 | 0.352 | White          | I-29      | 0.375 | 0.275 |
| CSWD-3-38-34   | #3 AWG    | #4 FLEX       | 3-6 AWG              | 3/8       | 0.406          | 0.750             | 1.687      | 0.625 | 2.567 | 0.593 | 0.414 | White          | I-29      | 0.375 | 0.275 |
| CSWD-3-38-1    | #3 AWG    | #4 FLEX       | 3-6 AWG              | 3/8       | 0.406          | 1.000             | 1.937      | 0.625 | 2.817 | 0.593 | 0.414 | White          | I-29      | 0.375 | 0.275 |
| CSWD-3-12-134  | #3 AWG    | #4 FLEX       | 3-6 AWG              | 1/2       | 0.562          | 1.750             | 3.000      | 0.625 | 3.880 | 0.750 | 0.546 | White          | I-29      | 0.375 | 0.275 |

All wire sizes, unless noted otherwise, are American Wire Gauge (AWG)

\* When installed with specified dieless tools

See pages 98 to 103 for complete tooling information.

For Bent Tangs change the 4th letter to a B and add "-4" for 45 deg. or "-9" for 90 deg.

UL File E6207

**A**

**TYPE  
CSWD**

**Features**

- Manufactured from high strength seamless copper tubing
- Electro-Tin plated
- Chamfered entry
- Color coded
- Suitable for use in circuits rated 35KV or less, proper high voltage spacing and insulation techniques must be used
- UL Listed and CSA Certified with ILSCO and major competitor's compression tools
- UL467 Listed 500 kcmil - 8 AWG , #8 - #2 SOL
- Rated to 90° C

**Benefits**

- Offers maximum conductivity and excellent crimping characteristics
- Provides low contact resistance
- For easy conductor insertion
- Identifies the proper compression die
- Application versatility
- Reduces inventory requirements
- For grounding and bonding applications

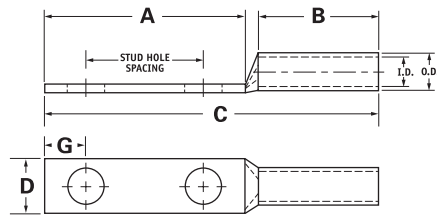

| Catalog Number  | Wire Size | Alt Wire Size | Expanded* Wire Range | Bolt Size | Stud Hole Dia. | Stud Hole Spacing | Dimensions |       |       |       |       | Die Color Code | Die Index | O.D.  | I.D.  |
|-----------------|-----------|---------------|----------------------|-----------|----------------|-------------------|------------|-------|-------|-------|-------|----------------|-----------|-------|-------|
|                 |           |               |                      |           |                |                   | A          | B     | C     | D     | G     |                |           |       |       |
| CSWD-2-10-34    | #2 AWG    | #2 SOL        | 2-6 AWG              | 10        | 0.219          | 0.750             | 1.437      | 0.625 | 2.348 | 0.599 | 0.258 | Brown          | I-33      | 0.421 | 0.312 |
| CSWD-2-14-58    | #2 AWG    | #2 SOL        | 2-6 AWG              | 1/4       | 0.281          | 0.625             | 1.437      | 0.625 | 2.348 | 0.599 | 0.320 | Brown          | I-33      | 0.421 | 0.312 |
| CSWD-2-14-34    | #2 AWG    | #2 SOL        | 2-6 AWG              | 1/4       | 0.281          | 0.750             | 1.437      | 0.625 | 2.348 | 0.599 | 0.320 | Brown          | I-33      | 0.421 | 0.312 |
| CSWD-2-14-1     | #2 AWG    | #2 SOL        | 2-6 AWG              | 1/4       | 0.281          | 1.000             | 1.687      | 0.625 | 2.598 | 0.599 | 0.320 | Brown          | I-33      | 0.421 | 0.312 |
| CSWD-2-516-34   | #2 AWG    | #2 SOL        | 2-6 AWG              | 5/16      | 0.343          | 0.750             | 1.687      | 0.625 | 2.598 | 0.599 | 0.352 | Brown          | I-33      | 0.421 | 0.312 |
| CSWD-2-516-1    | #2 AWG    | #2 SOL        | 2-6 AWG              | 5/16      | 0.343          | 1.000             | 1.937      | 0.625 | 2.848 | 0.599 | 0.352 | Brown          | I-33      | 0.421 | 0.312 |
| CSWD-2-38-34    | #2 AWG    | #2 SOL        | 2-6 AWG              | 3/8       | 0.406          | 0.750             | 1.687      | 0.625 | 2.598 | 0.599 | 0.414 | Brown          | I-33      | 0.421 | 0.312 |
| CSWD-2-38-78    | #2 AWG    | #2 SOL        | 2-6 AWG              | 3/8       | 0.406          | 0.875             | 1.937      | 0.625 | 2.848 | 0.599 | 0.414 | Brown          | I-33      | 0.421 | 0.312 |
| CSWD-2-38-1     | #2 AWG    | #2 SOL        | 2-6 AWG              | 3/8       | 0.406          | 1.000             | 1.937      | 0.625 | 2.848 | 0.599 | 0.414 | Brown          | I-33      | 0.421 | 0.312 |
| CSWD-2-38-134   | #2 AWG    | #2 SOL        | 2-6 AWG              | 3/8       | 0.406          | 1.750             | 2.625      | 0.625 | 3.536 | 0.599 | 0.414 | Brown          | I-33      | 0.421 | 0.312 |
| CSWD-2-12-134   | #2 AWG    | #2 SOL        | 2-6 AWG              | 1/2       | 0.562          | 1.750             | 3.000      | 0.625 | 3.911 | 0.750 | 0.546 | Brown          | I-33      | 0.421 | 0.312 |
| CSWD-1-14-58    | #1 AWG    | #2 FLEX       | 1-6 AWG              | 1/4       | 0.281          | 0.625             | 1.437      | 0.625 | 2.392 | 0.673 | 0.320 | Green          | I-37      | 0.468 | 0.359 |
| CSWD-1-14-34    | #1 AWG    | #2 FLEX       | 1-6 AWG              | 1/4       | 0.281          | 0.750             | 1.437      | 0.625 | 2.392 | 0.673 | 0.320 | Green          | I-37      | 0.468 | 0.359 |
| CSWD-1-14-1     | #1 AWG    | #2 FLEX       | 1-6 AWG              | 1/4       | 0.281          | 1.000             | 1.687      | 0.625 | 2.642 | 0.673 | 0.320 | Green          | I-37      | 0.468 | 0.359 |
| CSWD-1-516-78   | #1 AWG    | #2 FLEX       | 1-6 AWG              | 5/16      | 0.343          | 0.875             | 1.687      | 0.625 | 2.642 | 0.673 | 0.352 | Green          | I-37      | 0.468 | 0.359 |
| CSWD-1-516-1    | #1 AWG    | #2 FLEX       | 1-6 AWG              | 5/16      | 0.343          | 1.000             | 1.937      | 0.625 | 2.892 | 0.673 | 0.352 | Green          | I-37      | 0.468 | 0.359 |
| CSWD-1-38-1     | #1 AWG    | #2 FLEX       | 1-6 AWG              | 3/8       | 0.406          | 1.000             | 1.937      | 0.625 | 2.892 | 0.673 | 0.414 | Green          | I-37      | 0.468 | 0.359 |
| CSWD-1-12-134   | #1 AWG    | #2 FLEX       | 1-6 AWG              | 1/2       | 0.562          | 1.750             | 3.000      | 0.625 | 3.955 | 0.750 | 0.546 | Green          | I-37      | 0.468 | 0.359 |
| CSWD-1/0-14-58  | 1/0 AWG   | #1 FLEX       | 1/0-6 AWG            | 1/4       | 0.281          | 0.625             | 1.437      | 0.750 | 2.543 | 0.738 | 0.320 | Pink           | I-42      | 0.515 | 0.390 |
| CSWD-1/0-14-34  | 1/0 AWG   | #1 FLEX       | 1/0-6 AWG            | 1/4       | 0.281          | 0.750             | 1.437      | 0.750 | 2.543 | 0.738 | 0.320 | Pink           | I-42      | 0.515 | 0.390 |
| CSWD-1/0-14-1   | 1/0 AWG   | #1 FLEX       | 1/0-6 AWG            | 1/4       | 0.281          | 1.000             | 1.687      | 0.750 | 2.793 | 0.738 | 0.320 | Pink           | I-42      | 0.515 | 0.390 |
| CSWD-1/0-516-34 | 1/0 AWG   | #1 FLEX       | 1/0-6 AWG            | 5/16      | 0.343          | 0.750             | 1.687      | 0.750 | 2.793 | 0.738 | 0.352 | Pink           | I-42      | 0.515 | 0.390 |
| CSWD-1/0-516-78 | 1/0 AWG   | #1 FLEX       | 1/0-6 AWG            | 5/16      | 0.343          | 0.875             | 1.687      | 0.750 | 2.793 | 0.738 | 0.352 | Pink           | I-42      | 0.515 | 0.390 |
| CSWD-1/0-516-1  | 1/0 AWG   | #1 FLEX       | 1/0-6 AWG            | 5/16      | 0.343          | 1.000             | 1.937      | 0.750 | 3.043 | 0.738 | 0.352 | Pink           | I-42      | 0.515 | 0.390 |
| CSWD-1/0-38-1   | 1/0 AWG   | #1 FLEX       | 1/0-6 AWG            | 3/8       | 0.406          | 1.000             | 1.937      | 0.750 | 3.043 | 0.738 | 0.414 | Pink           | I-42      | 0.515 | 0.390 |
| CSWD-1/0-38-134 | 1/0 AWG   | #1 FLEX       | 1/0-6 AWG            | 3/8       | 0.406          | 1.750             | 2.625      | 0.750 | 3.731 | 0.738 | 0.414 | Pink           | I-42      | 0.515 | 0.390 |
| CSWD-1/0-12-1   | 1/0 AWG   | #1 FLEX       | 1/0-6 AWG            | 1/2       | 0.562          | 1.000             | 2.125      | 0.750 | 3.231 | 0.738 | 0.546 | Pink           | I-42      | 0.515 | 0.390 |
| CSWD-1/0-12-134 | 1/0 AWG   | #1 FLEX       | 1/0-6 AWG            | 1/2       | 0.562          | 1.750             | 3.000      | 0.750 | 4.106 | 0.738 | 0.546 | Pink           | I-42      | 0.515 | 0.390 |

All wire sizes, unless noted otherwise, are American Wire Gauge (AWG)

\* When installed with specified dieless tools See pages 98 to 103 for complete tooling information. For Bent Tangs change the 4th letter to a B and add "-4" for 45 deg. or "-9" for 90 deg.

UL File E6207

## TYPE CSWD

### Features

- Manufactured from high strength seamless copper tubing
- Electro-Tin plated
- Chamfered entry
- Color coded
- Suitable for use in circuits rated 35KV or less, proper high voltage spacing and insulation techniques must be used
- UL Listed and CSA Certified with ILSCO and major competitor's compression tools
- UL467 Listed 500 kcmil - 8 AWG , #8 - #2 SOL
- Rated to 90° C

### Benefits

- Offers maximum conductivity and excellent crimping characteristics
- Provides low contact resistance
- For easy conductor insertion
- Identifies the proper compression die
- Application versatility
- Reduces inventory requirements
- For grounding and bonding applications

A

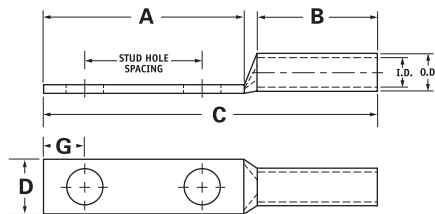

| Catalog Number   | Wire Size | Alt Wire Size | Expanded* Wire Range | Bolt Size | Stud Hole Dia. | Stud Hole Spacing | Dimensions |       |       |       |       | Die Color Code | Die Index | O.D.  | I.D.  |
|------------------|-----------|---------------|----------------------|-----------|----------------|-------------------|------------|-------|-------|-------|-------|----------------|-----------|-------|-------|
|                  |           |               |                      |           |                |                   | A          | B     | C     | D     | G     |                |           |       |       |
| CSWD-2/0-14-58   | 2/0 AWG   | 1/0 FLEX      | 2/0-4 AWG            | 1/4       | 0.281          | 0.625             | 1.437      | 0.750 | 2.583 | 0.811 | 0.320 | Black          | I-45      | 0.562 | 0.437 |
| CSWD-2/0-14-34   | 2/0 AWG   | 1/0 FLEX      | 2/0-4 AWG            | 1/4       | 0.281          | 0.750             | 1.437      | 0.750 | 2.583 | 0.811 | 0.320 | Black          | I-45      | 0.562 | 0.437 |
| CSWD-2/0-14-1    | 2/0 AWG   | 1/0 FLEX      | 2/0-4 AWG            | 1/4       | 0.281          | 1.000             | 1.687      | 0.750 | 2.833 | 0.811 | 0.320 | Black          | I-45      | 0.562 | 0.437 |
| CSWD-2/0-516-78  | 2/0 AWG   | 1/0 FLEX      | 2/0-4 AWG            | 5/16      | 0.343          | 0.875             | 1.687      | 0.750 | 2.833 | 0.811 | 0.352 | Black          | I-45      | 0.562 | 0.437 |
| CSWD-2/0-516-1   | 2/0 AWG   | 1/0 FLEX      | 2/0-4 AWG            | 5/16      | 0.343          | 1.000             | 1.937      | 0.750 | 3.083 | 0.811 | 0.352 | Black          | I-45      | 0.562 | 0.437 |
| CSWD-2/0-38-1    | 2/0 AWG   | 1/0 FLEX      | 2/0-4 AWG            | 3/8       | 0.406          | 1.000             | 1.937      | 0.750 | 3.083 | 0.811 | 0.414 | Black          | I-45      | 0.562 | 0.437 |
| CSWD-2/0-38-134  | 2/0 AWG   | 1/0 FLEX      | 2/0-4 AWG            | 3/8       | 0.406          | 1.750             | 2.625      | 0.750 | 3.771 | 0.811 | 0.414 | Black          | I-45      | 0.562 | 0.437 |
| CSWD-2/0-12-1    | 2/0 AWG   | 1/0 FLEX      | 2/0-4 AWG            | 1/2       | 0.562          | 1.000             | 2.125      | 0.750 | 3.271 | 0.811 | 0.546 | Black          | I-45      | 0.562 | 0.437 |
| CSWD-2/0-12-134  | 2/0 AWG   | 1/0 FLEX      | 2/0-4 AWG            | 1/2       | 0.562          | 1.750             | 3.000      | 0.750 | 4.146 | 0.811 | 0.546 | Black          | I-45      | 0.562 | 0.437 |
| CSWD-3/0-14-58   | 3/0 AWG   | 2/0 FLEX      | 3/0-2 AWG            | 1/4       | 0.281          | 0.625             | 1.437      | 0.750 | 2.626 | 0.885 | 0.320 | Orange         | I-50      | 0.609 | 0.484 |
| CSWD-3/0-14-34   | 3/0 AWG   | 2/0 FLEX      | 3/0-2 AWG            | 1/4       | 0.281          | 0.750             | 1.437      | 0.750 | 2.626 | 0.885 | 0.320 | Orange         | I-50      | 0.609 | 0.484 |
| CSWD-3/0-516-1   | 3/0 AWG   | 2/0 FLEX      | 3/0-2 AWG            | 5/16      | 0.343          | 1.000             | 1.937      | 0.750 | 3.126 | 0.885 | 0.352 | Orange         | I-50      | 0.609 | 0.484 |
| CSWD-3/0-38-1    | 3/0 AWG   | 2/0 FLEX      | 3/0-2 AWG            | 3/8       | 0.406          | 1.000             | 1.937      | 0.750 | 3.126 | 0.885 | 0.414 | Orange         | I-50      | 0.609 | 0.484 |
| CSWD-3/0-12-134  | 3/0 AWG   | 2/0 FLEX      | 3/0-2 AWG            | 1/2       | 0.562          | 1.750             | 3.000      | 0.750 | 4.189 | 0.885 | 0.546 | Orange         | I-50      | 0.609 | 0.484 |
| CSWD-4/0-14-58   | 4/0 AWG   | 3/0 FLEX      | 4/0-1 AWG            | 1/4       | 0.281          | 0.625             | 1.437      | 0.875 | 2.803 | 0.999 | 0.320 | Purple         | I-54      | 0.687 | 0.546 |
| CSWD-4/0-14-34   | 4/0 AWG   | 3/0 FLEX      | 4/0-1 AWG            | 1/4       | 0.281          | 0.750             | 1.437      | 0.875 | 2.803 | 0.999 | 0.320 | Purple         | I-54      | 0.687 | 0.546 |
| CSWD-4/0-14-1    | 4/0 AWG   | 3/0 FLEX      | 4/0-1 AWG            | 1/4       | 0.281          | 1.000             | 1.687      | 0.875 | 3.053 | 0.999 | 0.320 | Purple         | I-54      | 0.687 | 0.546 |
| CSWD-4/0-516-34  | 4/0 AWG   | 3/0 FLEX      | 4/0-1 AWG            | 5/16      | 0.343          | 0.750             | 1.687      | 0.875 | 3.053 | 0.999 | 0.352 | Purple         | I-54      | 0.687 | 0.546 |
| CSWD-4/0-516-1   | 4/0 AWG   | 3/0 FLEX      | 4/0-1 AWG            | 5/16      | 0.343          | 1.000             | 1.937      | 0.875 | 3.303 | 0.999 | 0.352 | Purple         | I-54      | 0.687 | 0.546 |
| CSWD-4/0-516-134 | 4/0 AWG   | 3/0 FLEX      | 4/0-1 AWG            | 5/16      | 0.343          | 1.750             | 2.500      | 0.875 | 3.866 | 0.999 | 0.352 | Purple         | I-54      | 0.687 | 0.546 |
| CSWD-4/0-38-1    | 4/0 AWG   | 3/0 FLEX      | 4/0-1 AWG            | 3/8       | 0.406          | 1.000             | 1.937      | 0.875 | 3.303 | 0.999 | 0.414 | Purple         | I-54      | 0.687 | 0.546 |
| CSWD-4/0-38-134  | 4/0 AWG   | 3/0 FLEX      | 4/0-1 AWG            | 3/8       | 0.406          | 1.750             | 2.625      | 0.875 | 3.991 | 0.999 | 0.414 | Purple         | I-54      | 0.687 | 0.546 |
| CSWD-4/0-12-1    | 4/0 AWG   | 3/0 FLEX      | 4/0-1 AWG            | 1/2       | 0.562          | 1.000             | 2.125      | 0.875 | 3.491 | 0.999 | 0.546 | Purple         | I-54      | 0.687 | 0.546 |
| CSWD-4/0-12-114  | 4/0 AWG   | 3/0 FLEX      | 4/0-1 AWG            | 1/2       | 0.562          | 1.250             | 2.500      | 0.875 | 3.866 | 0.999 | 0.546 | Purple         | I-54      | 0.687 | 0.546 |
| CSWD-4/0-12-134  | 4/0 AWG   | 3/0 FLEX      | 4/0-1 AWG            | 1/2       | 0.562          | 1.750             | 3.000      | 0.875 | 4.366 | 0.999 | 0.546 | Purple         | I-54      | 0.687 | 0.546 |

All wire sizes, unless noted otherwise, are American Wire Gauge (AWG)

\* When installed with specified dieless tools

See pages 98 to 103 for complete tooling information.

For Bent Tangs change the 4th letter to a B and add "-4" for 45 deg. or "-9" for 90 deg.

UL File E6207

**A**

## TYPE CSWD

### Features

- Manufactured from high strength seamless copper tubing
- Electro-Tin plated
- Chamfered entry
- Color coded
- Suitable for use in circuits rated 35KV or less, proper high voltage spacing and insulation techniques must be used
- UL Listed and CSA Certified with ILSCO and major competitor's compression tools
- UL467 Listed 500 kcmil - 8 AWG , #8 - #2 SOL
- Rated to 90° C

### Benefits

- Offers maximum conductivity and excellent crimping characteristics
- Provides low contact resistance
- For easy conductor insertion
- Identifies the proper compression die
- Application versatility
- Reduces inventory requirements
- For grounding and bonding applications

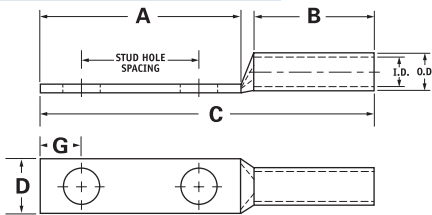

| Catalog Number   | Wire Size | Alt Wire Size                | Expanded* Wire Range | Bolt Size | Stud Hole Dia. | Stud Hole Spacing | Dimensions |       |       |       |       | Die Color Code | Die Index | O.D.  | I.D.  |
|------------------|-----------|------------------------------|----------------------|-----------|----------------|-------------------|------------|-------|-------|-------|-------|----------------|-----------|-------|-------|
|                  |           |                              |                      |           |                |                   | A          | B     | C     | D     | G     |                |           |       |       |
| CSWD-250-14-34   | 250kcmil  | 4/0 FLEX                     | 250kcmil - 1/0 AWG   | 1/4       | 0.281          | 0.750             | 1.437      | 1.063 | 3.031 | 1.088 | 0.320 | Yellow         | I-62      | 0.750 | 0.593 |
| CSWD-250-38-1    | 250kcmil  | 4/0 FLEX                     | 250kcmil - 1/0 AWG   | 3/8       | 0.406          | 1.00              | 1.937      | 1.063 | 3.531 | 1.088 | 0.414 | Yellow         | I-62      | 0.750 | 0.593 |
| CSWD-250-38-134  | 250kcmil  | 4/0 FLEX                     | 250kcmil - 1/0 AWG   | 3/8       | 0.406          | 1.750             | 2.625      | 1.063 | 4.219 | 1.088 | 0.414 | Yellow         | I-62      | 0.750 | 0.593 |
| CSWD-250-12-114  | 250kcmil  | 4/0 FLEX                     | 250kcmil - 1/0 AWG   | 1/2       | 0.562          | 1.250             | 2.500      | 1.063 | 4.094 | 1.088 | 0.546 | Yellow         | I-62      | 0.750 | 0.593 |
| CSWD-250-12-134  | 250kcmil  | 4/0 FLEX                     | 250kcmil - 1/0 AWG   | 1/2       | 0.562          | 1.750             | 3.000      | 1.063 | 4.594 | 1.088 | 0.546 | Yellow         | I-62      | 0.750 | 0.593 |
| CSWD-300-38-1    | 300kcmil  | 250 G,H FLEX                 | 300kcmil - 2/0 AWG   | 3/8       | 0.406          | 1.000             | 1.937      | 1.063 | 3.587 | 1.189 | 0.414 | White          | I-66      | 0.812 | 0.660 |
| CSWD-300-12-134  | 300kcmil  | 250 G,H FLEX                 | 300kcmil - 2/0 AWG   | 1/2       | 0.562          | 1.750             | 3.000      | 1.063 | 4.650 | 1.189 | 0.546 | White          | I-66      | 0.812 | 0.660 |
| CSWD-350-14-34   | 350kcmil  | 250 I,K,M FLEX 262.2 DLO     | 350kcmil - 3/0 AWG   | 1/4       | 0.281          | 0.750             | 1.437      | 1.063 | 3.123 | 1.291 | 0.320 | Red            | I-71      | 0.890 | 0.703 |
| CSWD-350-516-134 | 350kcmil  | 250 I,K,M FLEX 262.2 DLO     | 350kcmil - 3/0 AWG   | 5/16      | 0.343          | 1.750             | 2.500      | 1.063 | 4.186 | 1.291 | 0.352 | Red            | I-71      | 0.890 | 0.703 |
| CSWD-350-38-1    | 350kcmil  | 250 I,K,M FLEX 262.2 DLO     | 350kcmil - 3/0 AWG   | 3/8       | 0.406          | 1.000             | 1.937      | 1.063 | 3.623 | 1.291 | 0.414 | Red            | I-71      | 0.890 | 0.703 |
| CSWD-350-12-114  | 350kcmil  | 250 I,K,M FLEX 262.2 DLO     | 350kcmil - 3/0 AWG   | 1/2       | 0.562          | 1.250             | 2.500      | 1.063 | 4.186 | 1.291 | 0.546 | Red            | I-71      | 0.890 | 0.703 |
| CSWD-350-12-134  | 350kcmil  | 250 I,K,M FLEX 262.2 DLO     | 350kcmil - 3/0 AWG   | 1/2       | 0.562          | 1.750             | 3.000      | 1.063 | 4.686 | 1.291 | 0.546 | Red            | I-71      | 0.890 | 0.703 |
| CSWD-400-38-1    | 400kcmil  | 300 G,H,I,K,M FLEX 313.1 DLO | 400kcmil - 4/0 AWG   | 3/8       | 0.406          | 1.000             | 1.937      | 1.188 | 3.792 | 1.365 | 0.414 | Blue           | I-76      | 0.937 | 0.750 |
| CSWD-400-38-116  | 400kcmil  | 300 G,H,I,K,M FLEX 313.1 DLO | 400kcmil - 4/0 AWG   | 3/8       | 0.406          | 1.062             | 1.937      | 1.188 | 3.792 | 1.365 | 0.414 | Blue           | I-76      | 0.937 | 0.750 |
| CSWD-400-12-134  | 400kcmil  | 300 G,H,I,K,M FLEX 313.1 DLO | 400kcmil - 4/0 AWG   | 1/2       | 0.562          | 1.750             | 3.000      | 1.188 | 4.855 | 1.365 | 0.546 | Blue           | I-76      | 0.937 | 0.750 |
| CSWD-500-14-34   | 500kcmil  | 350 G,H,I,K,M FLEX 373.7 DLO | 500kcmil - 250kcmil  | 1/4       | 0.281          | 0.750             | 1.437      | 1.300 | 3.469 | 1.535 | 0.320 | Brown          | I-87      | 1.062 | 0.828 |
| CSWD-500-38-1    | 500kcmil  | 350 G,H,I,K,M FLEX 373.7 DLO | 500kcmil - 250kcmil  | 3/8       | 0.406          | 1.000             | 1.937      | 1.300 | 3.969 | 1.535 | 0.414 | Brown          | I-87      | 1.062 | 0.828 |
| CSWD-500-12-114  | 500kcmil  | 350 G,H,I,K,M FLEX 373.7 DLO | 500kcmil - 250kcmil  | 1/2       | 0.562          | 1.250             | 2.500      | 1.300 | 4.532 | 1.535 | 0.546 | Brown          | I-87      | 1.062 | 0.828 |
| CSWD-500-12-134  | 500kcmil  | 350 G,H,I,K,M FLEX 373.7 DLO | 500kcmil - 250kcmil  | 1/2       | 0.562          | 1.750             | 3.000      | 1.300 | 5.032 | 1.535 | 0.546 | Brown          | I-87      | 1.062 | 0.828 |

All wire sizes, unless noted otherwise, are American Wire Gauge (AWG)

\* When installed with specified dieless tools See pages 98 to 103 for complete tooling information.

For Bent Tangs change the 4th letter to a B and add "-4" for 45 deg. or "-9" for 90 deg.

UL File E6207

## TYPE CSWD

### Features

- Manufactured from high strength seamless copper tubing
- Electro-Tin plated
- Chamfered entry
- Color coded
- Suitable for use in circuits rated 35KV or less, proper high voltage spacing and insulation techniques must be used
- UL Listed and CSA Certified with ILSCO and major competitor's compression tools
- UL467 Listed 500 kcmil - 8 AWG , #8 - #2 SOL
- Rated to 90° C

### Benefits

- Offers maximum conductivity and excellent crimping characteristics
- Provides low contact resistance
- For easy conductor insertion
- Identifies the proper compression die
- Application versatility
- Reduces inventory requirements

**A**

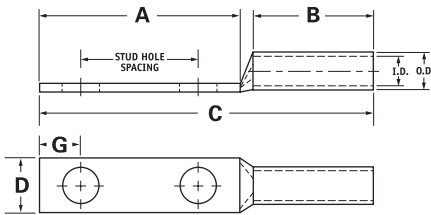

| Catalog Number   | Wire Size | Alt Wire Size                | Expanded* Wire Range | Bolt Size | Stud Hole Dia. | Stud Hole Spacing | Dimensions |       |       |       |       | Die Color Code | Die Index | O.D.  | I.D.  |
|------------------|-----------|------------------------------|----------------------|-----------|----------------|-------------------|------------|-------|-------|-------|-------|----------------|-----------|-------|-------|
|                  |           |                              |                      |           |                |                   | A          | B     | C     | D     | G     |                |           |       |       |
| CSWD-600-38-1    | 600kcmil  | 400 G,H,I,K,M FLEX 444.4 DLO | 600kcmil - 250kcmil  | 3/8       | 0.406          | 1.000             | 1.937      | 1.375 | 4.121 | 1.712 | 0.414 | Green          | I-94      | 1.187 | 0.920 |
| CSWD-600-12-134  | 600kcmil  | 400 G,H,I,K,M FLEX 444.4 DLO | 600kcmil - 250kcmil  | 1/2       | 0.562          | 1.750             | 3.000      | 1.375 | 5.184 | 1.712 | 0.546 | Green          | I-94      | 1.187 | 0.920 |
| CSWD-650-12-134  | 650kcmil  | 500 G,H,I,K,M FLEX 535.3 DLO | 650kcmil - 350kcmil  | 1/2       | 0.562          | 1.750             | 3.000      | 1.375 | 5.244 | 1.764 | 0.546 | Pink           | I-99      | 1.217 | 0.958 |
| CSWD-650-12-114  | 650kcmil  | 500 G,H,I,K,M FLEX 535.3 DLO | 650kcmil - 350kcmil  | 1/2       | 0.562          | 1.250             | 2.500      | 1.375 | 4.744 | 1.764 | 0.546 | Pink           | I-99      | 1.217 | 0.958 |
| CSWD-650-38-1    | 650kcmil  | 500 G,H,I,K,M FLEX 535.3 DLO | 650kcmil - 350kcmil  | 3/8       | 0.406          | 1.000             | 1.937      | 1.375 | 4.181 | 1.764 | 0.414 | Pink           | I-99      | 1.217 | 0.958 |
| CSWD-650-38-118  | 650kcmil  | 500 G,H,I,K,M FLEX 535.3 DLO | 650kcmil - 350kcmil  | 3/8       | 0.406          | 1.125             | 2.125      | 1.375 | 4.369 | 1.764 | 0.414 | Pink           | I-99      | 1.217 | 0.958 |
| CSWD-650-516-1   | 650kcmil  | 500 G,H,I,K,M FLEX 535.3 DLO | 650kcmil - 350kcmil  | 1/32      | 0.343          | 1.000             | 1.937      | 1.375 | 4.181 | 1.764 | 0.352 | Pink           | I-99      | 1.217 | 0.958 |
| CSWD-700-38-1    | 700kcmil  | 500 G,H,I,K,M FLEX 535.3 DLO | 700kcmil - 350kcmil  | 3/8       | 0.406          | 1.000             | 1.937      | 1.375 | 4.181 | 1.816 | 0.414 | Pink           | I-99      | 1.250 | 0.991 |
| CSWD-700-12-114  | 700kcmil  | 500 G,H,I,K,M FLEX 535.3 DLO | 700kcmil - 350kcmil  | 1/2       | 0.562          | 1.250             | 2.500      | 1.375 | 4.744 | 1.816 | 0.546 | Pink           | I-99      | 1.250 | 0.991 |
| CSWD-700-12-134  | 700kcmil  | 500 G,H,I,K,M FLEX 535.3 DLO | 700kcmil - 350kcmil  | 1/2       | 0.562          | 1.750             | 3.000      | 1.375 | 5.244 | 1.816 | 0.546 | Pink           | I-99      | 1.250 | 0.991 |
| CSWD-700-12-178  | 700kcmil  | 500 G,H,I,K,M FLEX 535.3 DLO | 700kcmil - 350kcmil  | 1/2       | 0.562          | 1.875             | 3.000      | 1.375 | 5.244 | 1.816 | 0.546 | Pink           | I-99      | 1.250 | 0.991 |
| CSWD-750-38-1    | 750kcmil  | 600 G,H,I,M FLEX 646.4 DLO   | 750kcmil - 500kcmil  | 3/8       | 0.406          | 1.000             | 1.937      | 1.500 | 4.339 | 1.901 | 0.414 | Black          | I-106     | 1.313 | 1.031 |
| CSWD-750-38-118  | 750kcmil  | 600 G,H,I,M FLEX 646.4 DLO   | 750kcmil - 500kcmil  | 3/8       | 0.406          | 1.125             | 2.125      | 1.500 | 4.527 | 1.901 | 0.414 | Black          | I-106     | 1.313 | 1.031 |
| CSWD-750-12-112  | 750kcmil  | 600 G,H,I,M FLEX 646.4 DLO   | 750kcmil - 500kcmil  | 1/2       | 0.562          | 1.500             | 2.625      | 1.500 | 5.027 | 1.901 | 0.546 | Black          | I-106     | 1.313 | 1.031 |
| CSWD-750-12-134  | 750kcmil  | 600 G,H,I,M FLEX 646.4 DLO   | 750kcmil - 500kcmil  | 1/2       | 0.562          | 1.750             | 3.000      | 1.500 | 5.402 | 1.901 | 0.546 | Black          | I-106     | 1.313 | 1.031 |
| CSWD-750-58-112  | 750kcmil  | 600 G,H,I,M FLEX 646.4 DLO   | 750kcmil - 500kcmil  | 5/8       | 0.656          | 1.500             | 3.000      | 1.500 | 5.402 | 1.901 | 0.671 | Black          | I-106     | 1.313 | 1.031 |
| CSWD-1000-38-1   | 1000kcmil | 750 G,H,I FLEX 777.7 DLO     | 1000kcmil - 750kcmil | 3/8       | 0.406          | 1.000             | 1.937      | 1.625 | 4.587 | 2.169 | 0.414 | White          | I-125     | 1.500 | 1.172 |
| CSWD-1000-12-114 | 1000kcmil | 750 G,H,I FLEX 777.7 DLO     | 1000kcmil - 750kcmil | 1/2       | 0.562          | 1.250             | 2.500      | 1.625 | 5.150 | 2.169 | 0.546 | White          | I-125     | 1.500 | 1.172 |
| CSWD-1000-12-134 | 1000kcmil | 750 G,H,I FLEX 777.7 DLO     | 1000kcmil - 750kcmil | 1/2       | 0.562          | 1.750             | 3.000      | 1.625 | 5.650 | 2.169 | 0.546 | White          | I-125     | 1.500 | 1.172 |
| CSWD-1000-58-112 | 1000kcmil | 750 G,H,I FLEX 777.7 DLO     | 1000kcmil - 750kcmil | 5/8       | 0.656          | 1.500             | 3.000      | 1.625 | 5.650 | 2.169 | 0.671 | White          | I-125     | 1.500 | 1.172 |

All wire sizes, unless noted otherwise, are American Wire Gauge (AWG)

\* When installed with specified dieless tools See pages 98 to 103 for complete tooling information. For Bent Tangs change the 4th letter to a B and add "-4" for 45 deg. or "-9" for 90 deg. UL File E6207