

PowerFlex 750-Series EMC Plate and Core(s) – Frames 1...7

Frames 1...5 (400...480V AC)

Frames 3...5 (600V AC)

Frames 6...7 (600...690V AC)

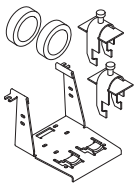

20-750-EMC1-F1
Frame 1
400...480V AC

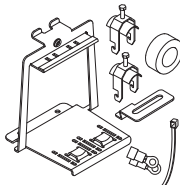

20-750-EMC1-F2, F3
Frames 2...3
400...480V AC

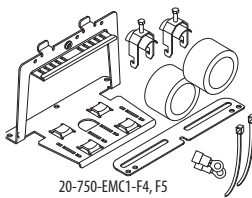

20-750-EMC1-F4, F5
Frames 4...5*
400...480V AC

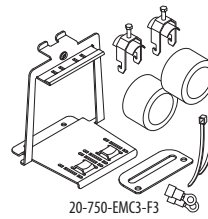

20-750-EMC3-F3
Frame 3
600V AC

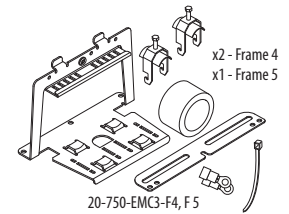

20-750-EMC3-F4, F5
Frames 4...5
600V AC

x2 - Frame 4
x1 - Frame 5

* Frames 6...7, 400...480V drives do not require EMC cores or plates to meet EMC requirements.

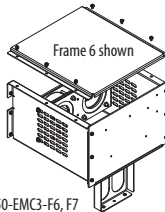

20-750-EMC3-F6, F7
Frames 6...7, IP00 (IP20 after installation)
600...690V AC

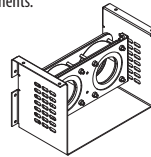

20-750-EMC5-F6, F7
Frames 6...7, IP54
600...690V AC

Frame 6 shown

IMPORTANT

Grounding and power jumper configuration must be appropriate for EMC applications. Refer to "Drive Power Jumper Configuration" in the PowerFlex 750-Series Installation Instructions (Publication [750-IN001](#)) for details.

